

BROKER PRICE OPINION

Stock # **10FLPUTGL000042**

Parcel # **6132818300000000**

Property Address: **Moon Lake Drive** City: **Crescent City** State: **FL** Zip Code: **32112**

The above premises was inspected on: 4/21/2014 by: **Ray Casali - Avenue 1 Realty Group LLC**

The property was: Vacant Occupied

Is the exterior in good repair? Yes No Is the house & yard free from debris? Yes No

Has the property been boarded, screened, or otherwise secured? Yes No Keybox Yes No

Has the property been vandalized? Yes No

Is there an HOA on this property? Yes No

Details: This lot is a heavily wooded lot in a residential area. There are a few mobile homes and some regular homes in the surrounding area. There is ample vacant land surrounding the lot. There is minimal value. The demographics in the area are poor to low income.

Exterior repairs needed (in order of importance) to market property. Give a "best knowledge" estimate of costs.

_____ \$

_____ \$

_____ \$

_____ \$

_____ \$

_____ \$

_____ \$

_____ \$

_____ \$

_____ \$

_____ \$

_____ \$

Color Exterior/Interior Photos Attached

NEIGHBORHOOD DATA

Property Values: Increasing Declining Stable

Supply/Demand: Shortage Abundance Normal

Marketing Time: Under 3 Months 4 - 6 Months Over 6 Months

Price Range: (Neighborhood) High **\$320,000** Low **\$4,200**

Number of houses in Direct Competition with Subject: 6 Number of sales in the past 6 months: 2

Appraisal/Room count provided by lender: Yes No

SUBJECT PROPERTY

Address	Style	Age	SQ FT	# Rms	# BRs	# Baths	Gar/CP	List Price	List Date	Fin Terms
Moon Lake Dr	6.52 acres									

CURRENT HOMES FOR SALE

Competitive Listings	Style	Age	SQ FT	# Rms	# BRs	# Baths	Gar/CP	List Price	List Date	Days on Market	Prox to Subject
14949 W Hwy 100, Bunnell	7.5 acres							\$49,000	5/30/13	356	5 mi
16065 W Hwy 100, Bunnell	8.6 acres							\$55,900	4/17/10	1494	12 mi
101 Mill St, Ponomo Park	25.18 acres							\$299,000	6/3/2013	358	10.5 mi

CLOSED PROPERTIES

Competitive Sales	Style	Age	SQ FT	# Rms	# BRs	# Baths	Gar/CP	List Price	Sale Price	Date Closed	Days on Market	Prox to Subject
781 Georgetown Denver Rd	6.11 acres							\$59,000	\$14,000	1/24/14	645	2.02 mi
117 Thorn Rd	10.1 acres							\$19,900	\$14,500	5/6/14	266	9.83 mi

Highway 17	6.5 acres						\$18,000	\$15,000	6/15/12	297	6.2 mi
-------------------	------------------	--	--	--	--	--	-----------------	-----------------	----------------	------------	---------------

Please supply comps even if distance is a factor. Explain any absence of available comps, i.e., no sales, etc.:

Best available comps used. Due to a lack of comparables in the immediate area, search was expanded to neighboring areas that are comparable in demographics. There is a lack of sold comps in the past few months due to a lack of buyers/developers for this type of products.

Not all comp photos are available.

PROPERTY VALUES

For Ninety (90) Day Market Period:	<u>\$14,000</u>	As Is Condition:	<u>\$14,000</u>
		Repaired:	<u>\$14,000</u>
For Thirty (30) Day Market Period:	<u>\$10,000</u>	Quick Sale:	<u>\$10,000</u>
		Recommended List Price:	<u>\$18,900</u>

MARKETABILITY

What current market conditions will affect the sale of the home? Available financing?

Cash buyer.

What are the positives/negatives of the property?

Heavily wooded lot. Dirt roads.

How do the comps that were used compare to the subject?

Best comps used.

Note specific items that could be a potential problem:

Unknown HOA.

Checklist of Damages

Is there any vandalism?: Yes No **If yes, Where?**

n/a

Is there any graffiti?: Yes No **If yes, Where?**

n/a

Is there any damage that appears to be caused by an act of nature?:

Yes No **If yes, Where?**

n/a

Are there any broken windows?: Yes No **If yes, Where?**

n/a

Are there any broken doors?: Yes No **If yes, Where?**

n/a

Does anything appear to be missing? (i.e., HVAC, door knobs, fencing) :

Yes No **If yes, Where?**

n/a

What is the condition and approx. age of roof?:

Yes No **If yes, Where?**

n/a

Is this home boarded? :

Yes No **If yes, Where?**

n/a

Digital Photo Addendum

Moon Lake Drive

Crescent City, FL 32112



Front



Side View



Street View



Map

Comparable Properties

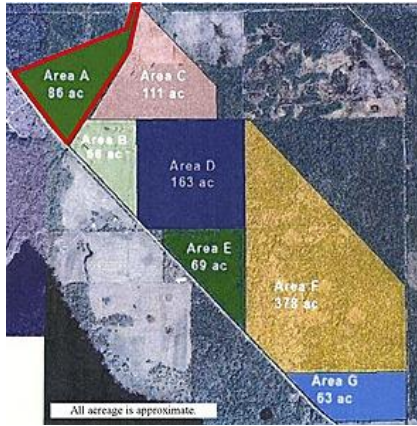

List comp 2



List comp 3



Sold comp 1



Sold comp 2



Sold comp 3